

GERMANICA

3.8kW

PORTABLE WI-FI AIR CONDITIONER

GPA38KW



INSTRUCTION MANUAL

Please read this manual carefully before using, and keep it for future reference.

CONTENTS

General Safety	4
Product Overview	9
Accessories List	10
Control Panel	11
Remote Control	11
Installation	12
Window Kit Installation	14
Instructions	
Using the Portable Air Conditioner	15
Cooling Mode	16
Dehumidifying Mode	16
Fan Mode	16
Auto Swing	16
Sleep Mode	16
Timer Operation	16
Water Full Alarm	17
App / Wi-Fi Control	18
Connecting app to Google Home /Amazon Alexa	23
Cleaning and Maintenance	24
Wi-Fi Troubleshooting	25
Troubleshooting	26
Specifications	27
Customer Helpline	Last Page

GENERAL SAFETY

Read this manual thoroughly before you start using the portable air con.

Store this manual, the completed warranty card, your receipt and the product packaging. The safety precautions instructions reduces the risk of fire, electric shock and injury when correctly complied to.

Please follow all instructions and take notice of all warnings.

Please follow instruction when installing this product in accordance with the instruction manual. This product must be positioned in a sufficiently stable location, it can be potentially hazardous due to falling when mounted and can cause injury, particularly to children if it positioned incorrectly.

- Before installing this aircon, make sure your outlet voltage corresponds to the voltage stated on the power supply rating label
- Do not use a damaged power cord, plug or loose outlet. Doing so may cause an electric shock.
- If the power cord is damaged, it must be replaced by the manufacturer or a qualified service technician.
- Do not plug several devices into the same outlet. Doing so may cause the outlet to overheat and start a fire. Make sure the outlet is readily accessible during operation of the equipment.
- Do not bend, twist or kink the power cord excessively.
- Do not allow anything to rest on or roll over the power cord. Doing so may cause a fire or an electric shock.
- Do not run the power cord near heat-producing appliances such as radiators, stoves or irons. The excessive heat could melt the insulation and expose live wires, resulting in fire or electric shock.
- Do not expose the air conditioner to water. The electrical insulation could be damaged and cause electrocution. Do not touch the unit when barefoot or parts of your body are wet or damp.
- This appliance is not intended for use by persons (including children) with reduced physical, sensory or mental capabilities, or lack of experience and knowledge, unless they have been given supervision or instruction concerning use of the appliance by a person responsible for their safety.
Children should be supervised to ensure that they do not play with the appliance.
- If the supply cord is damaged, it must be replaced by the manufacturer, its service agent or similarly qualified persons in order to avoid a hazard.
- This appliance is intended for air conditioning indoor domestic environments. It is not suitable for commercial, industrial or trade use. Do not use it for any other purpose (such as drying clothes, cooling food, etc.), and only use it as described in this manual. Working environment temperature range 18°C-35°C.

GENERAL SAFETY INSTRUCTIONS (Cont.)

- Do not cover the ventilation openings of the product with items such as newspapers, tablecloths, curtains etc or insert objects into the slots available on the products. As this could result in the product temperature rising and could cause a fire.
- If you notice any unusual odors or smoke around the unit, immediately disconnect the unit from the outlet and contact the service center. Failure to do so may result in fire or electric shock.
- When not using the unit for long periods of time or when you are moving the unit please ensure to disconnect the power supply from the wall socket.
- Please beware that Dust could accumulate over time on the unit and cause it to generate heat and or deteriorate insulation, which in turn may result in an electrical fire.
- The product is not intended for use by persons (including children) with reduced physical, sensory or mental capabilities, or young children of any age, They must be supervised by a person responsible for their safety.
- Batteries from the remote control must be only removed by an adult, the adult must ensure to keep them out of reach of infants and children. Seek medical attention immediately if a child has swallowed a battery.
- To maintain the product do not use any chemical or cleaning agent or wet cloth, please only ensure to utilize a dry cloth to wipe it down from marks or dust and only after unplugging the product from the power socket.
- Always use the air con with the air filter mounted. Using it without the air filter can cause accumulation of dust or waste on the inner parts of the device with possible subsequent failters.
- Do not direct airflow directly onto plants or animals, as long exposure can affect them.
- Please ensure to contact our call center for any repair or service required for the products not doing so will make warranty on your product void.
- We assume not liability for any eventual damages to property or injury to persons caused by misuse of the product or noncompliance with these instructions.

Please make sure upon positioning this product, the place is:

- Not wet or damp and Well ventilated
- Away from direct sunlight or heaters.
- Away from splashes or food.
- Protected from excessive dust or grease.
- Do not place containers with liquids, if liquid falls inside the products it may result in short-circuit, fire or electric shock.
- Do not place small metallic objects on top of the unit or block the openings as it will reduce operating efficiency of the air con with failures or damages.

GENERAL SAFETY INSTRUCTIONS (Cont.)

- This appliance is intended for air conditioning indoor domestic environments. It is not suitable for commercial, industrial or trade use. Do not use it for any other purpose (such as drying clothes, cooling food, etc.), and only use it as described in this manual.
- Do not use the unit outdoors. It is for indoor use only.
- This appliance is not intended for use by persons (including children) with reduced physical, sensory or mental capabilities, or lack of experience and knowledge, unless they have been given supervision or instruction concerning use of the appliance in a safe way and understand the hazards involved.
- **WARNING: Do not cover!** Do not cover the air conditioner or obstruct any air inlet or outlet grilles. Obstructing these openings causes a fire hazard, reduces the operating efficiency and may lead to malfunction or damage.
- Do not insert any objects, or your fingers, into the air outlet, and make sure to warn children of the dangers. Keep ventilation openings clear of obstructions.
- Supervise children to ensure they do not play with the appliance. Close supervision is necessary when any appliance is used by or near children. Cleaning and user maintenance shall not be made by children without supervision.

DO NOT INSTALL/USE THE APPLIANCE IN THE FOLLOWING AREAS:

- outdoors or where water is likely to splash
- near a bath, shower, laundry basin or swimming pool
- in an area where oil is likely to splash
- near a hot gas or electric burner, or sources of fire
- near sources of heat, or exposed to direct sunlight
- in an area where furniture or other objects can obstruct the airflow
- in the presence of flammable substances or vapour such as alcohol, insecticides, petrol, etc.
- at a dry cleaner's premises.

R32-SPECIFIC SAFETY ADVICE:

WARNING: Combustible & Dangerous

This symbol alerts you to take care as the appliance contains a flammable refrigerant: R32 (difluoromethane). Take extra care when installing the unit and when carrying out maintenance. R32 is an odourless hydrocarbon gas with a high level of environmental compatibility, with just one third of the global warming potential (GWP) and a zero ozone depleting potential (ODP).



Warning: low burning velocity material

While R32 is flammable and can explode under certain conditions, there will be no risk of burning and explosion if the appliance is properly installed and maintained following all instructions and safety advice in the supplied manuals.

GENERAL SAFETY INSTRUCTIONS (Cont.)

- There must be a clearance of at least 30cm between the walls, furniture, curtains or any other obstacles (refer to below image). Maintaining this minimum 30cm clearance is essential; failure to keep that distance can result in the unit malfunctioning or causing injury.
- The air exhaust can be installed in a vertical or horizontal sliding window. (refer to below image)
- Keep the length of the air exhaust hose to the minimum length necessary during operation.
- Place the unit on a flat surface to reduce the risk of it tipping over. Do not tilt the unit, always keep it upright during installation and use.
- We accept no responsibility for any eventual injuries or damages caused by improper installation, faulty use or failure to follow the instructions.

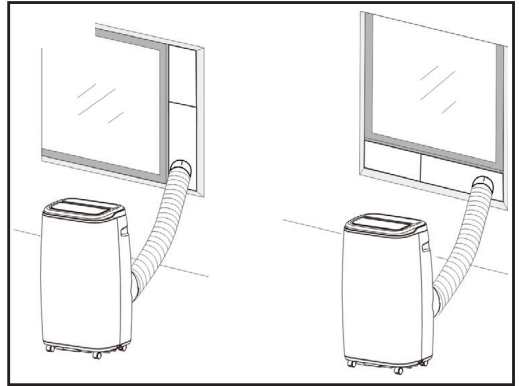
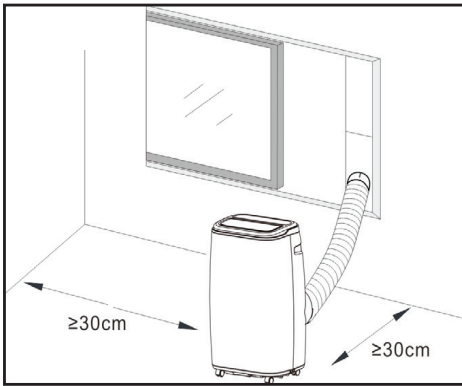

Pressure specifications:

Permissible excessive operating pressure	Discharge 2.6MPa
	Suction 1.0MPa
Maximum allowable pressure	Discharge 3.2MPa
	Suction 1.2MPa

GENERAL SAFETY INSTRUCTIONS (Cont.)

WARNING:

- Do not expose the appliance to high heat, sparks and open flames.
- Do not pierce or burn the appliance.
- Do not use means to accelerate the defrosting process or to clean, other than those recommended by the manufacturer.
- Be aware that refrigerants may not contain an odour.
- This air conditioner has been fully charged with refrigerant at the factory.
Should a recharge become necessary, it may only be recharged by a professional installer.
- Maintenance must only be carried out by properly qualified, authorised personnel.
If the appliance requires maintenance or service, contact our after sales support centre info@ayonz.com
- **The service technician must strictly comply with:**
 - all safety instructions in the manual provided with the appliance
 - all relevant provisions of gas-related local laws and regulations.

Electric shock hazard!

Before installation, cleaning or or servicing, ensure the unit is switched off and disconnected from the power outlet to prevent possible injury.





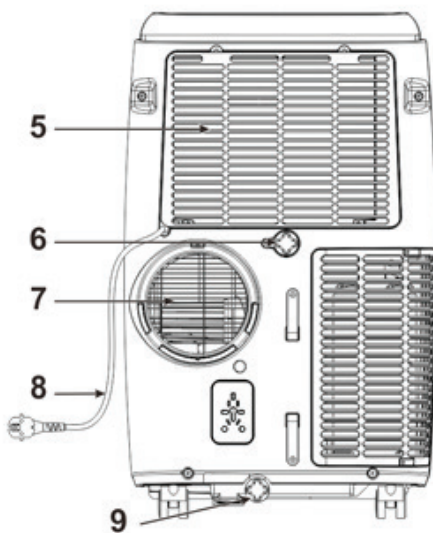
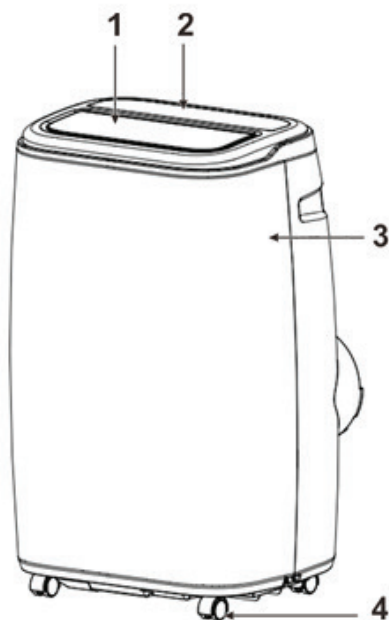

PRODUCT OVERVIEW

- 1 Louvre
- 2 Control panel
- 3 Front panel
- 4 Castor wheels
- 5 Air inlet
- 6 Drainage outlet
- 7 Air outlet
- 8 Power cord and plug
- 9 Drainage outlet



PRODUCT OVERVIEW (CONT.)

ACCSESORY PARTS

Part	Description
	Flexible air exhaust hose
	Exhaust hose connector (window end)
	Exhaust hose connector (housing adaptor) (air conditioner end)
	Remote control
	Adjustable window slider (for 67.5cm - 123cm windows)
	2 Dowels
	2 AAA-size batteries (packaged separately)

PRODUCT OVERVIEW (CONT.)

Control panel

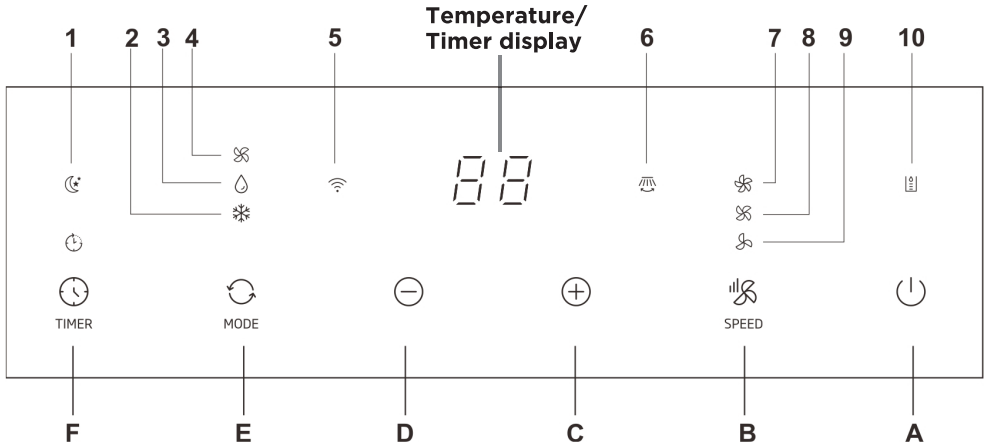

A	Power on/off	3	Dehumidifying
B	Fan speed	4	Fan
C	Temperature up	5	WIFI function
D	Temperature down	6	Auto swing
E	Operation mode	7	High fan speed
F	Timer on/off	8	Medium fan speed
1	Sleep mode	9	Low fan speed
2	Cooling	10	Water full

Remote control

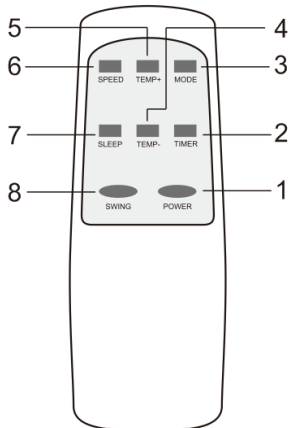

1	POWER	Power on/off
2	TIMER	Timer on/off
3	MODE	Operation MODE
4	TEMP-	Temperature down
5	TEMP+	Temperature up
6	SPEED	Fan speed
7	SLEEP	Sleep mode
8	SWING	Auto swing

INSTALLATION





When the portable air conditioner is operating, the unit draws in indoor air and exhausts hot air out of the room to complete the air exchange.

CAUTION: The window kit must be installed before operating the unit.

When the unit is in FAN MODE, no outdoor air exchange takes place. The window kit and exhaust to not need to be installed when the unit is used as a fan.

Note: The supplied window kit can be installed in sliding windows and sliding glass doors.. When installed, be sure to keep the exhaust hose short and straight as possible for maximum efficiency.

WINDOW KIT

Part	Description
	Flexible air exhaust hose
	Exhaust hose connector (window end)
	Exhaust hose connector (housing adaptor) (air conditioner end)
	Adjustable window slider (for 67.5cm - 123cm windows)
	2 Dowels

INSTALLATION (Cont.)

Please follow the below steps in order to setup your portable air conditioner.

Fit the exhaust hose and housing connectors to the ends of the flexible air exhaust hose, twisting them into place

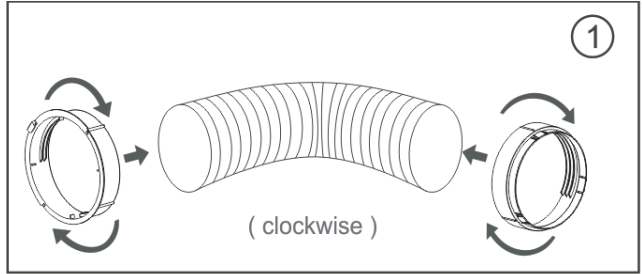

Insert the fixing clip of the housing connector into the openings at the back of the air conditioner.

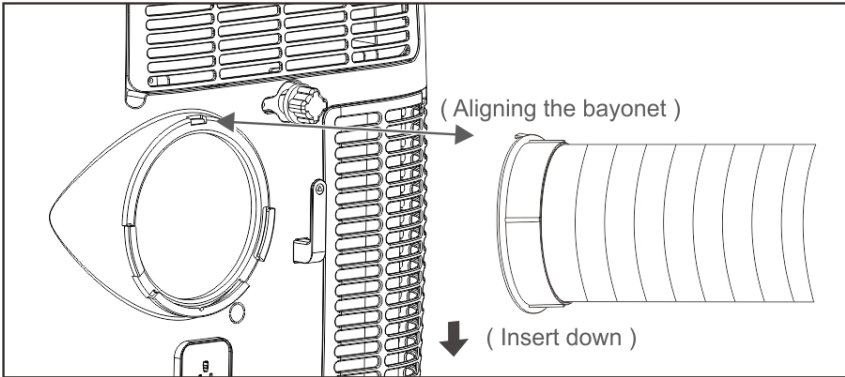

For temporary installation (in fan mode only), lead the exhaust hose connector (window end) out of an open window.

NOTE: Ambient air will still be able to enter the room this way. To cool the room effectively, the window kit must be properly installed.

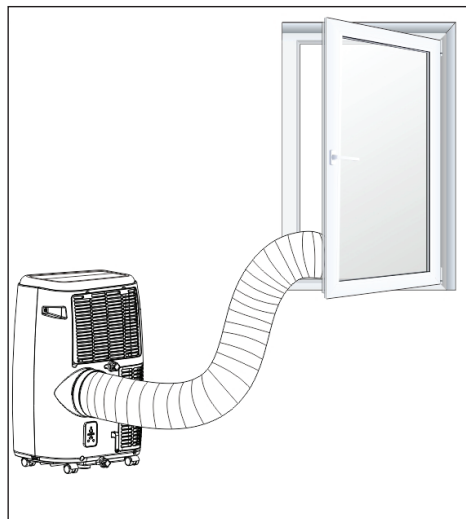

INSTALLATION (Cont.)

Installing the window kit

Your window kit has been designed to fit most standard 'horizontal' and 'vertical' window applications, but for certain types of windows it may be necessary for you to improvise/modify some aspects of the installation procedure.

Adjust the window slider to the length of a horizontally (or height of a vertically) opening window and fix it with a dowel.

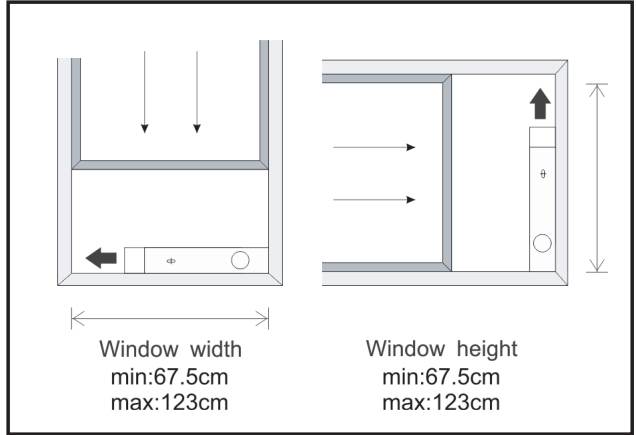

- Fit the slider to the bottom of the window sill (or to the side of the window, if it opens vertically), then close the window.
- Fit the exhaust hose connector (window end) through the opening to the outside.

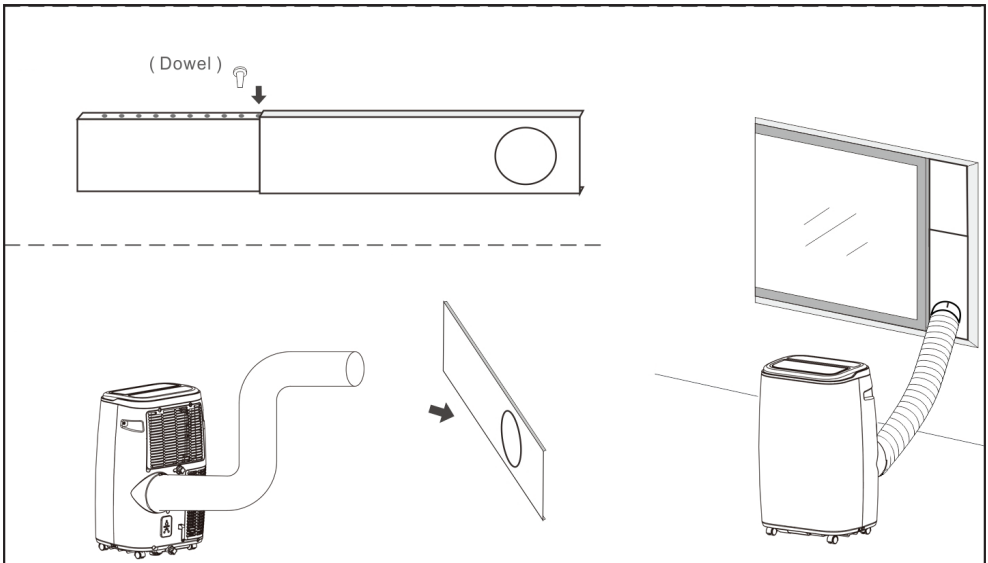

INSTRUCTIONS

Using the portable air conditioner

- Before switching the unit on for the first time, make sure you have properly installed the exhaust hose and window kit inserted two AAA size batteries into the remote control.
- Find a place for the air conditioner where there is a power outlet nearby.

Install the exhaust hose through the window kit so that the hot air is expelled to the outside.

Ensure the rubber stoppers at the back of the appliance are properly in place to block the drainage outlets.

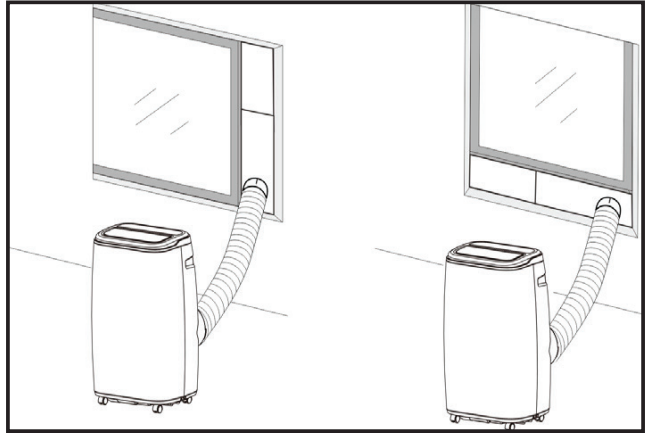

- Press the POWER button and the unit will start operation.

IMPORTANT INFORMATION

- As the compressor is inside the room, a portable air conditioner makes more noise than a split system, where the compressor is outside.
- For best cooling efficiency, keep blinds and curtains closed during the sunniest part of the day. Close off any fireplace damper, floor and/or wall register so cool air does not escape through the chimney or duct work.
- After switching on, allow 30 seconds for cool air to flow through the louvres. Avoid starting the air conditioner soon after switching off, and avoid switching it off immediately after switching on. Allow at least 3 minutes in between switching the unit on and then off, or vice versa.

INSTRUCTIONS (Cont.)

Cooling Mode

- Press the MODE button until the cooling mode indicator illuminates.
- Press the DOWN (-) or UP (+) button repeatedly to set the desired room temperature between 16°C and 31°C.
- Press the SPEED button to select the fan speed: high, medium or low.

NOTE: For best cooling efficiency, make sure that:

- * Curtains/blinds are closed if your room is directly exposed to the sun.
- * The air conditioner is located away from any heat source.

Dehumidifying mode

- Press the MODE button until the dehumidifying mode indicator illuminates.
- The unit will automatically set the fan motor to low speed and maintain the room temperature at 2°C lower than the current room temperature (within the 16°C to 31°C range).

Fan mode

- Press the MODE button until the fan mode indicator illuminates.
- Press the SPEED button to select the fan speed.

Auto swing

- When the unit is running, press the SWING button to start automatic oscillation. The louvre will swing continuously up and down.
- Press this button again to stop automatic oscillation and the louvre will remain in that position.

Sleep mode

- While in cooling mode, press the SLEEP button to increase the temperature gradually by two degrees for night-time use.
- In Sleep mode, the set temperature will increase by 1°C after an hour and by another degree after 2 hours.
- Press the SLEEP button again to cancel Sleep mode.

Timer Operation

- The air conditioner has a 24 hour timer, which you can set to start the unit at a later time, or to switch off the unit automatically.

INSTRUCTIONS (Cont.)

On-Timer Setting

- With the unit switched off (but power supplied), press the TIMER button and then use the UP and DOWN buttons to select the number of hours after which you want the unit to turn on. The selected number of hours will be shown on the display.

Off-Timer Setting

- Use the same procedure as above, but while the unit is switched on, to set an auto-off time. The selected number of hours will be shown on the display.

Water Full Alarm

Condensation water that forms during cooling will drop into an in-built drip tray. When the water level in the drip tray is getting too full, an automatic water level sensor illuminates the Water Full indicator on the control panel to alert you that the drip tray needs to be emptied.

- Place a pan under the water drainage outlet at the bottom of the unit.
Alternatively, attach a water drain hose (not supplied) to a drainage outlet.
- Remove the respective rubber stopper and drain all water out of the tray.

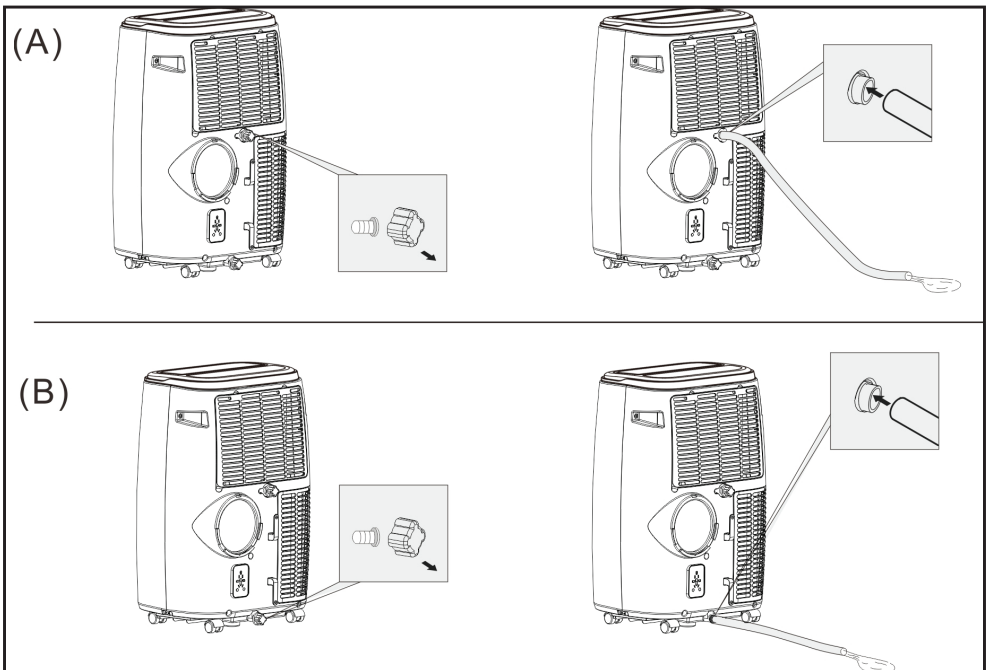

APP / Wi-Fi Control

Working with your mobile device, using your home Wi-Fi network router to communicate with the portable air conditioner and control it.

Controlling the portable air conditioner remotely is very easy.

You will need:

- Android smartphone or tablet, or an Apple iPhone or iPad
- Internet connection at your home
- Wi-Fi network router set up at home.

You must also have the **Tuya Smart** App installed or updated on your smartphone or mobile device. This app is available from Google Play Store or Apple App Store.

Initial set-up

Upon completing setup of your portable air conditioner, or when you have changed your mobile device or wireless router, you will have to set up the communication between the devices.

In order to do this, make sure you have the **Tuya Smart** App installed or updated on your mobile device, your Wi-Fi router is switched on and your mobile device connected to your home Wi-Fi network.

On your mobile device, tap on the **Tuya Smart** app (1). It will open and take you to the Login Page (2).

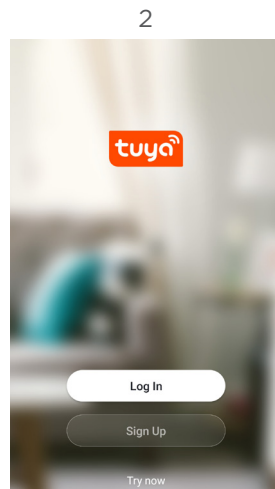
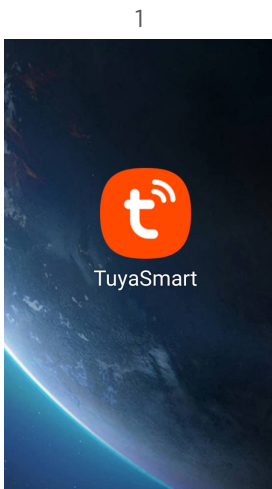

APP / Wi-Fi Control (Cont.)

Before you log in, please press **REGISTER** and register your account using an email address. (3 and 4)

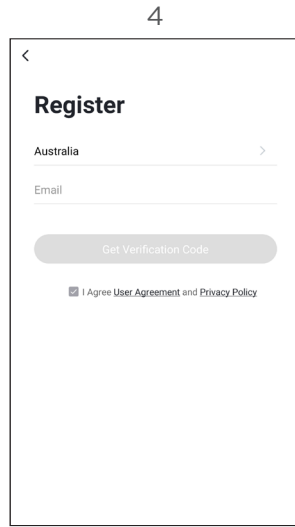
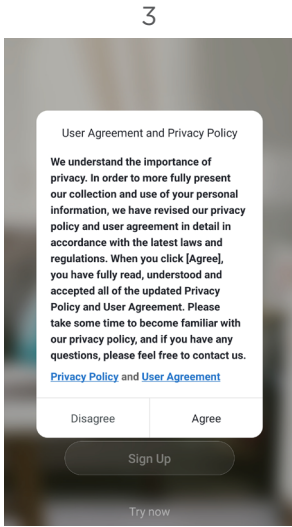

Once entered email address, tap **GET VERIFICATION CODE** and an email will be sent your email address with a verification code. Enter this code.

Now you can enter a password for your account. Please remember this password or write it down. (5)

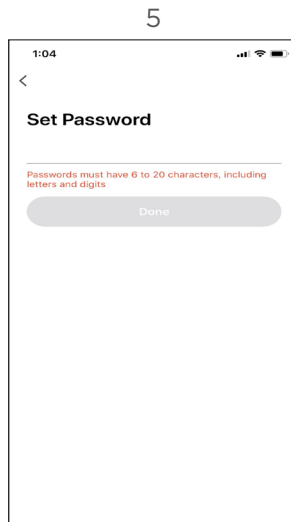

APP / Wi-Fi Control (Cont.)

1. On the air conditioner's remote control (or control panel), press and hold the SPEED button for 5 seconds to reset the Wi-Fi module.
2. When the Wi-Fi indicator on the control panel will blink rapidly (5), the Wi-Fi module is ready for configuration with your mobile phone.

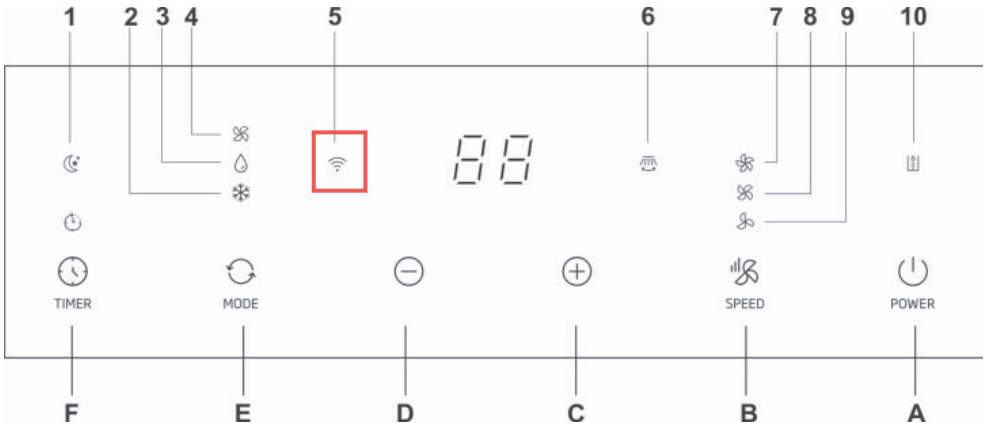

3. On your mobile device, tap **[Confirm indicator rapidly blinks]** and enter your Wi-Fi name and password, then tap **[Confirm]**. The message **“Connecting”** will appear on the screen.

APP / Wi-Fi Control (Cont.)

You will now enter device list.

1. Tap the plus (+) or **ADD DEVICE** to add your device. (7).
2. Select the type of product which in this case is: FAN. (8)
3. Select Wi-Fi network then enter in the password to connect. (9)

Note: Make sure to select 2.4GHz **NOT** a 5GHz Wi-Fi network.

5GHz Wi-Fi Network will not work with this app.

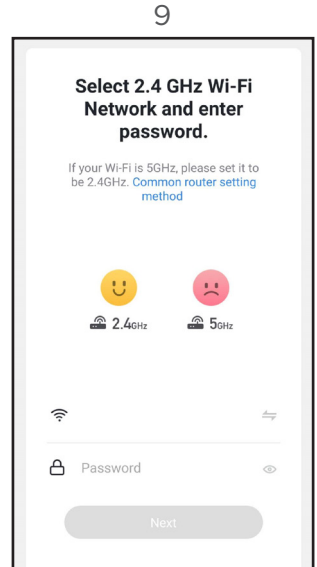
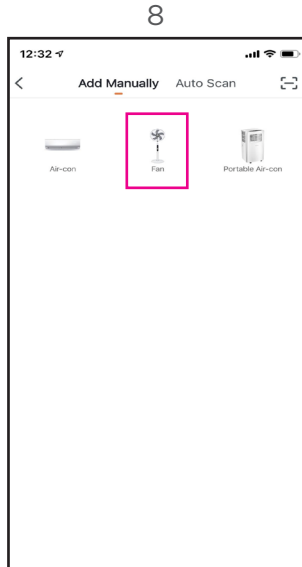
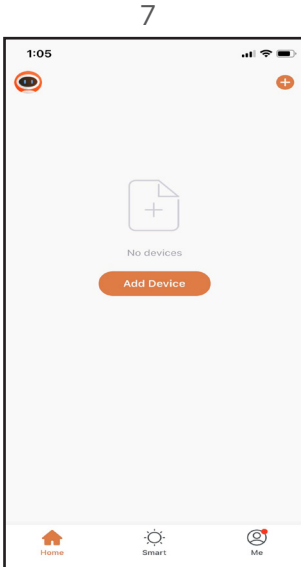

Now that you have already reset the Wi-Fi module on page 24 and the Wi-Fi indicator is blinking fast, your device will now be ready to connect to your smartphone as to the image to the right (10).

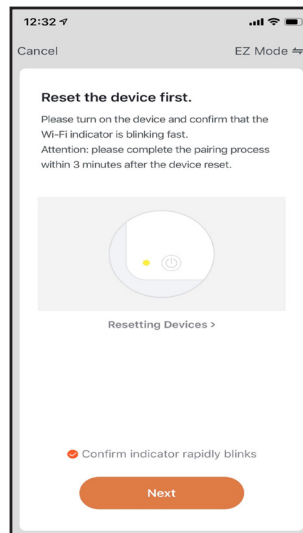

APP / Wi-Fi Control (Cont.)

Now that the device is being added, progress screen will now appear as to below: (11, 12, 13).

11

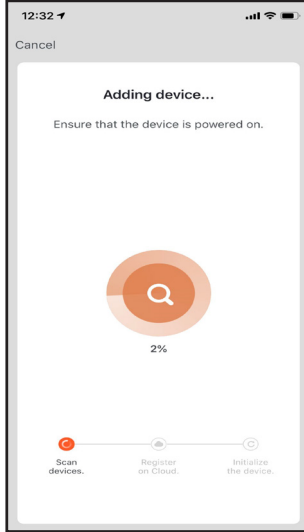

12

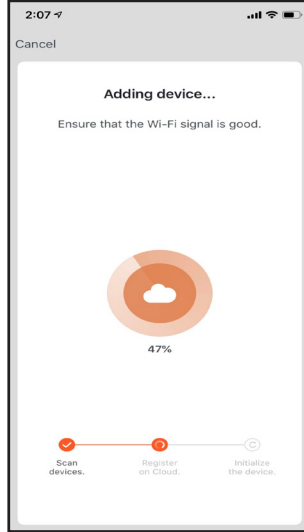

13

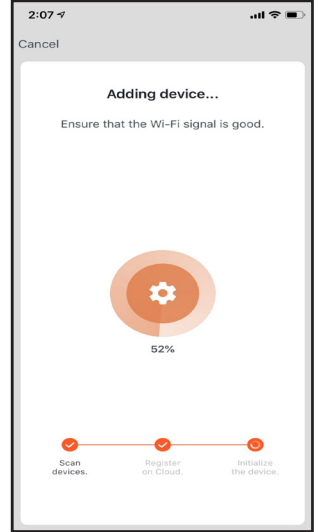

Once completed, it will show your product is now added. click **DONE**. Click on the device name and you can now start navigating the controls of the app. (14, 15)

14

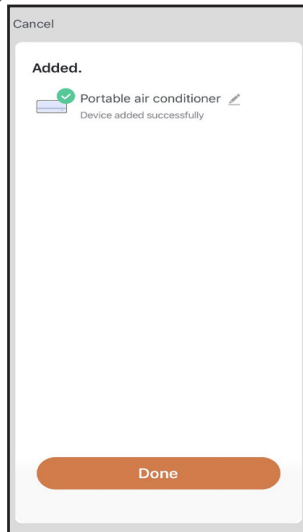

15

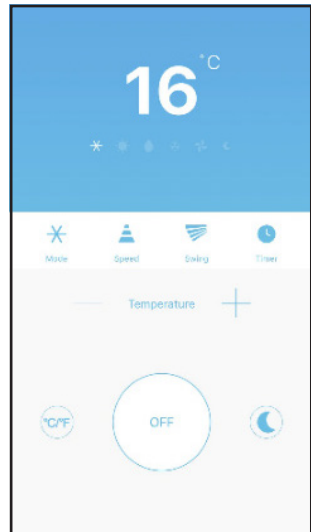

APP / Wi-Fi Control (Cont.)

Add the Tuya Smart app to your Google Home app.

1. Open your Google home app.
(Before you link your app to your Google Home app, you will have to have a Google Home account already set up.)
2. From the home screen of the Google Home App, press **ADD**. Press **SET UP DEVICE**, then select **HAVE SOMETHING ALREADY SET UP?** under the **WORKS WITH GOOGLE** banner.
3. Search for Tuya Smart.
4. Press the **Tuya Smart** app and enter your **Tuya Smart** app account details and password.
Then press **SIGN IN**.

Add the Tuya Smart app to your Amazon Alexa Account.

You must have to already have an Amazon Alexa account set up.

1. Home screen of Amazon Alexa app, press the **3 bars** in the top left hand corner. **Select SKILLS & GAMES**, then search for **Tuya Smart**.
2. Select the **Tuya Smart** app, Ensure you have followed the steps listed, then select **CONFIRMED** and then select **NEXT**. Enter your **Tuya Smart** account details and password then press **SIGN IN**.

* Instructions for adding **Tuya Smart** app are general instructions only. Detailed steps or specific message from your Google Home or Amazon Alexa account may vary depending on the version.

Smartphone and Wi-Fi specification requirements

Minimum smartphone specifications

Android 5.0 version or later

IOS 9.0 version or later

CLEANING & MAINTENANCE

Electric shock hazard!

Before cleaning and servicing, ensure the unit is switched off and disconnected from the power outlet to prevent possible injury.

Cleaning the air conditioner

Wipe the housing with a damp cloth, moistened with water and a little mild detergent. Dry with a soft, dry cloth.

CAUTION: Do not wash the unit directly. Do not use any solvent or alcohol based cleaning agent on any surface. Using such harsh cleansers will scratch or damage the surface, or can even lead to deformation of the housing.

Cleaning the air filter

This unit has an air intake filter at the back of the unit. If the air filter clogs up with dust, the airflow volume will be reduced. We recommend cleaning the filter once every two weeks.

To remove the filter, follow below:

- Open the air inlet grille and take off the air filter.
- Clean the air filter with a mild detergent in lukewarm water (max. 40 °C). Rinse thoroughly.
- Let all parts dry completely in the shade before reinstallation.

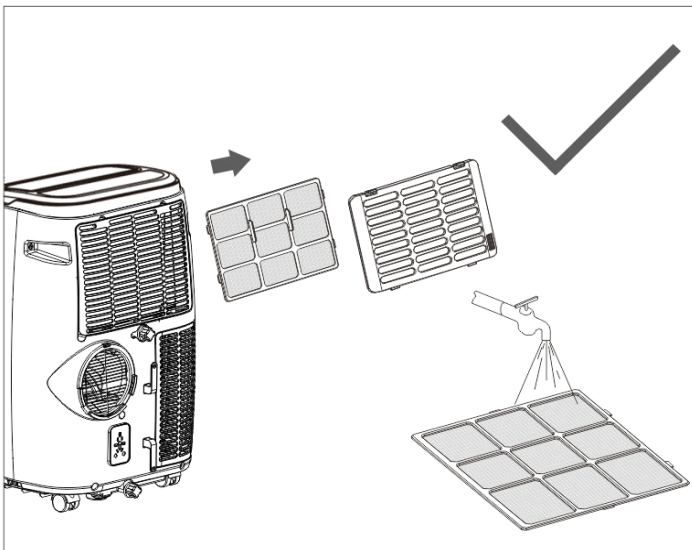

WI-FI TROUBLESHOOTING

Problem	Possible cause and solution
<p>During the set-up, the portable air conditioner cannot be configured successfully.</p>	<p>Check and ensure you have internet reception and your mobile phone and the air conditioner are connected to the same Wi-Fi network.</p>
	<p>Check and ensure your Wi-Fi password is correct.</p>
	<p>Check and ensure that no firewalls or other restrictions are set.</p>
	<p>Check and ensure that the router works normally – check the network requirements.</p>
	<p>Ensure that the portable air conditioner, router and mobile are all on the same Wi-Fi network and within the signal range.</p>
<p>I cannot control the air conditioner with my mobile.</p>	<p>If a message is displayed to alert you to an identification failure, the portable air conditioner has been reset and the mobile phone lost control permission. You need to reconnect the phone to the portable air conditioner, following the set-up instructions in this manual.</p> <p>If after these steps you still cannot control the portable air conditioner with your mobile, please delete the portable air conditioner from your device list and reconnect again.</p>
<p>My mobile phone cannot find the air conditioner.</p>	<p>If a message is displayed to alert you that the device is offline, please check and ensure that your portable air conditioner is connected to your mains supply and power is switched on at the outlet.</p> <p>Also ensure that your router is connected to the mains supply and that the router and your mobile phone are properly connected to your Wi-Fi network.</p>

TROUBLESHOOTING

If you experience problems with your portable air conditioner, or it appears not to be operating correctly, check the information below for solutions to common problems. If none of the solutions offered help you solve your problem, please contact our support centre for advice on info@ayonz.com

Do not attempt to repair the appliance yourself!

Problem	Possible Causes	Solution
Unit does not start when pressing the POWER button.	The water full (FULL) indicator blinks, indicating that the drip tray is full.	Drain the condensation water manually.
	The room temperature is lower than the set temperature.	Reset the temperature.
Low cooling performance.	Doors or windows to the room are open.	Ensure all windows and doors to the room are closed.
	There are heat sources inside the room.	Remove the heat sources, if possible.
	The exhaust air hose is not connected, or blocked.	Connect or clean the exhaust air hose.
	The set temperature is too high.	Reset the temperature.
	The air inlet is blocked.	Clean the air inlet.
Noisy	The ground is not level or not flat enough.	Make sure to place the unit on a flat, level ground.
	The sound comes from the refrigerant flowing inside the air conditioner.	This is normal and no cause for concern.
E0 Code	The room temperature sensor failed.	Call for service to replace the part (the unit can also work without replacement).
E1 Code	Condenser temperature sensor failed.	Call for service to replace the part.
E2 Code	Water drip tray is full.	Drain the water manually out of the drip tray.
E3 Code	Evaporator temperature sensor failed.	Call for service to replace the part.

SPECIFICATIONS

Power Supply	220-240V ~ 50Hz	
Rated Power	POWER	1461 W
	CURRENT	7.0 A
Capacity	COOLING	3800W (3.8kW)
Weight	NET	32.5 kg
	GROSS	35.5 kg
Indoor Dishcharge Air-Flow	DISCHARGE	≥ 380m ³ /h
Refrigerant Type	TYPE	R32
	QUANTITY	430 g
Noise Level	≤ 65 dB(A)	
Dimensions	UNIT	440 (h) x 357 (w) x 690 (d) mm

This appliance has been fully tested and meets all requirements as set out by standards AS/NZS 60335.1 and AS/NZS 60335.2.40.

GER ANICA

CUSTOMER HELPLINE:

info@ayonz.com

DISTRIBUTED BY:

AYONZ PTY LTD